

BR-05

QUANTIDADE: 02  
AMBIENTES: Vestiário Fem./Masc. (Térreo)

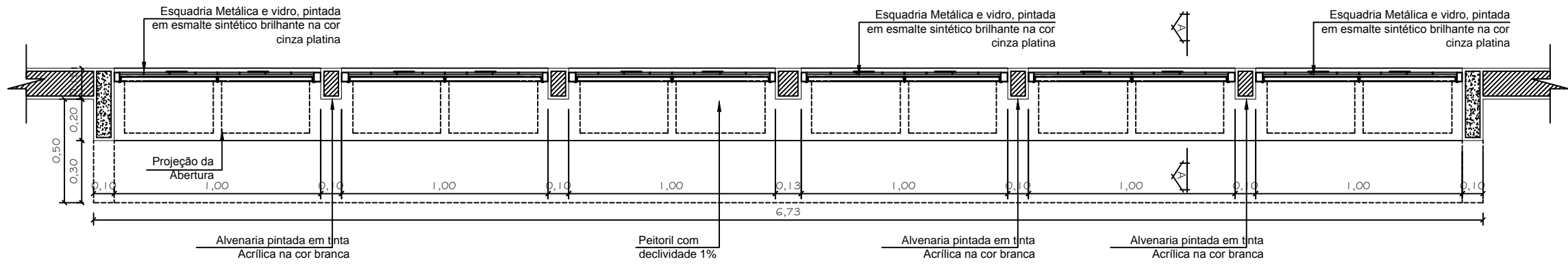

PLANTA BAIXA  
Brises Janela Vest. Fem./Masc.  
Escala: 1/25

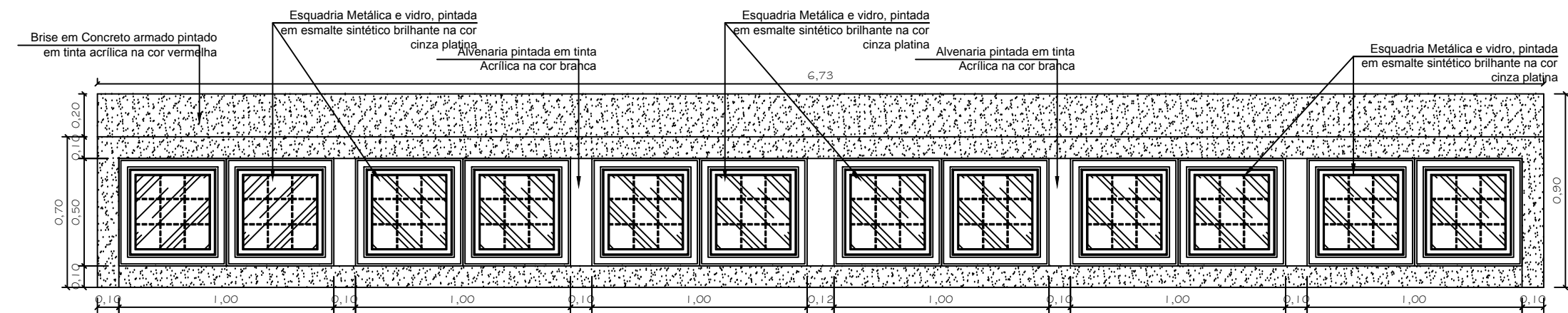

VISTA FRONTAL  
Brises Janela Vest. Fem./Masc.  
Escala: 1/25

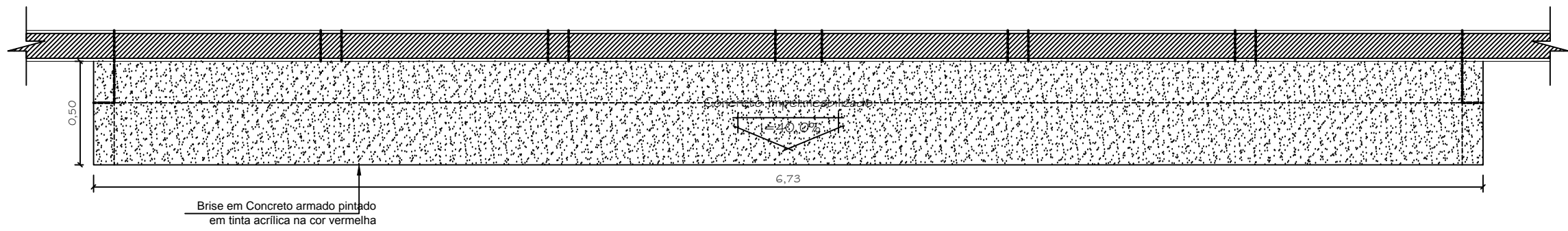

PLANTA SUPERIOR  
Brises Janela Vest. Fem./Masc.  
Escala: 1/25

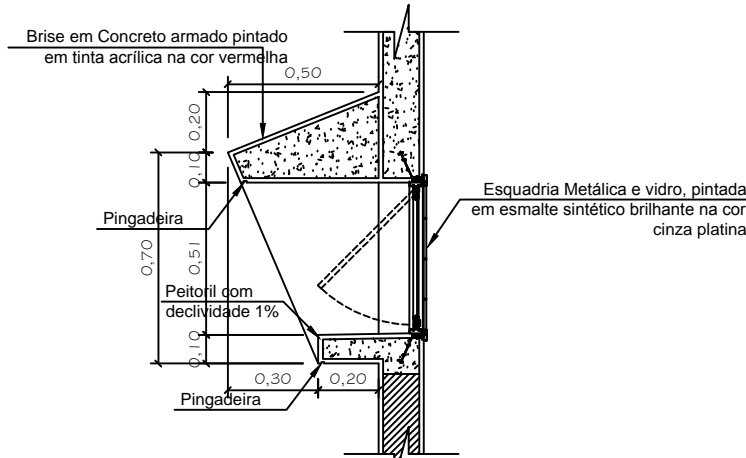

CORTE AA  
Brises Janela Vest. Fem./Masc.  
Escala: 1/25

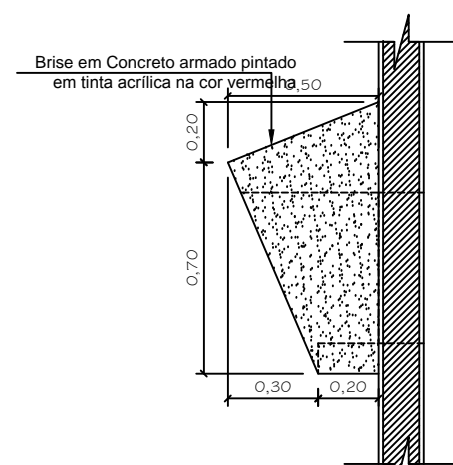

VISTA LATERAL  
Brises Janela Vest. Fem./Masc.  
Escala: 1/25

BR-07

QUANTIDADE: 02  
AMBIENTES: Wc. Infantil Fem./Masc. (Superior)

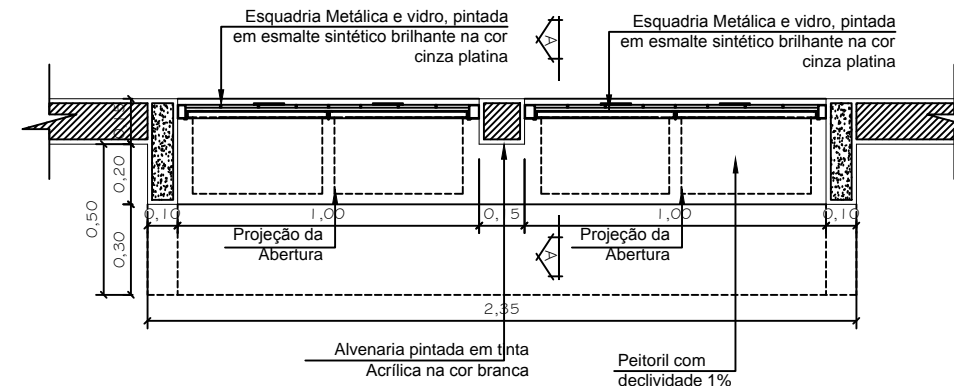

PLANTA BAIXA  
Brise Janela Wc. Inf. Fem./Masc.  
Escala: 1/25

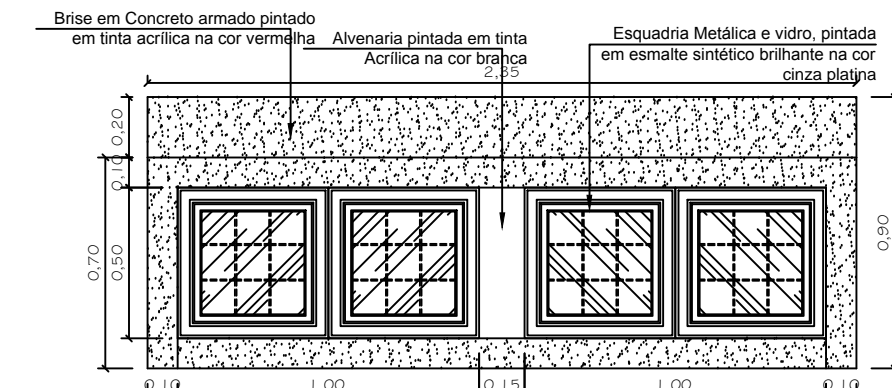

VISTA FRONTAL  
Brise Janela Wc. Inf. Fem./Masc.  
Escala: 1/25

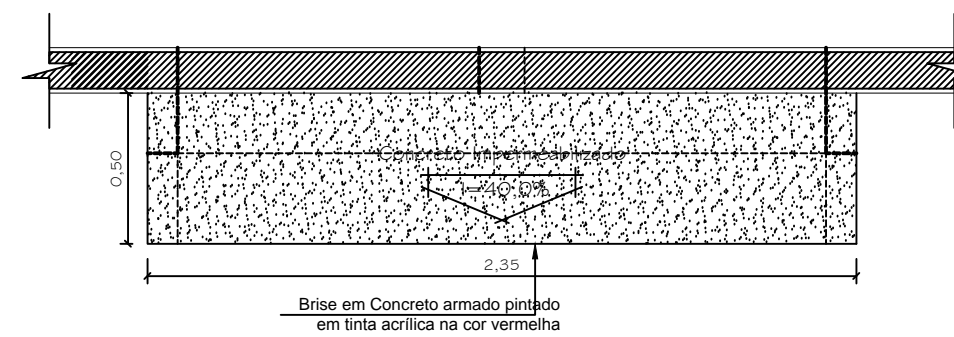

PLANTA SUPERIOR  
Brise Janela Wc. Inf. Fem./Masc.  
Escala: 1/25

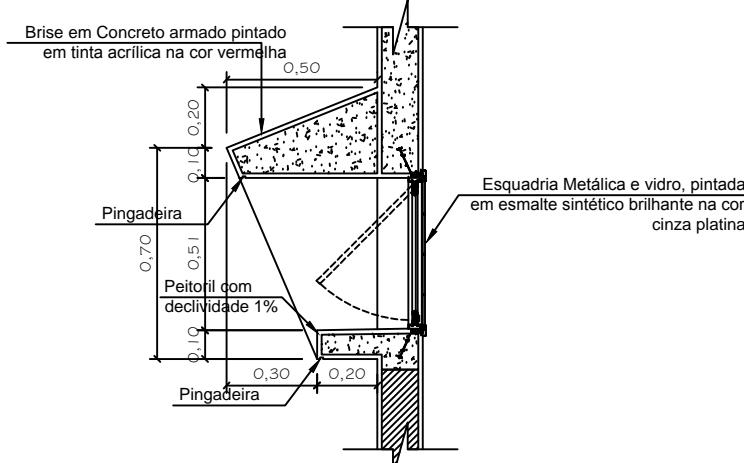

CORTE AA  
Brise Janela Wc. Inf. Fem./Masc.  
Escala: 1/25

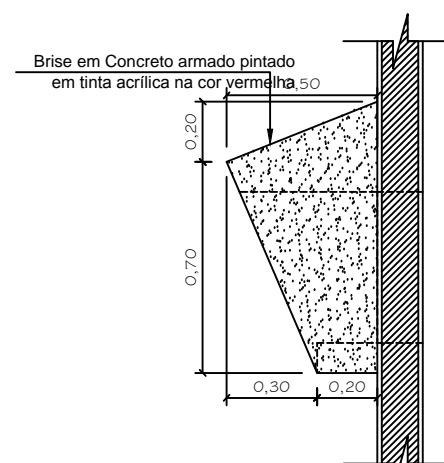

VISTA LATERAL  
Brise Janela Wc. Inf. Fem./Masc.  
Escala: 1/25

BR-06

QUANTIDADE: 02  
AMBIENTES: Wc. Fem./Masc. (Pav. Superior)

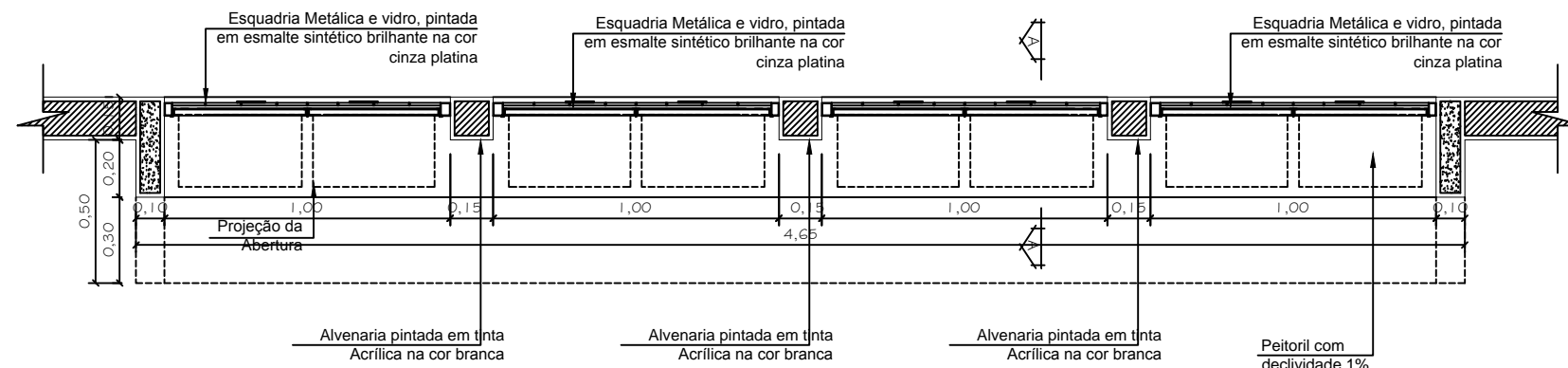

PLANTA BAIXA  
Brises Janela Wc. Fem./Masc.  
Escala: 1/25

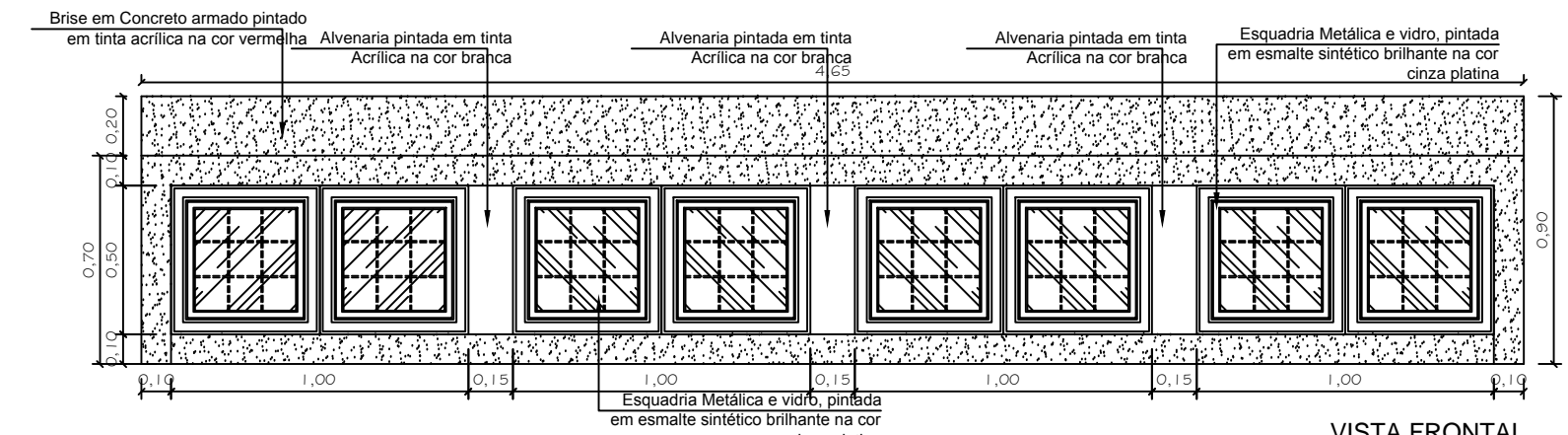

VISTA FRONTAL  
Brises Janela Wc. Fem./Masc.  
Escala: 1/25

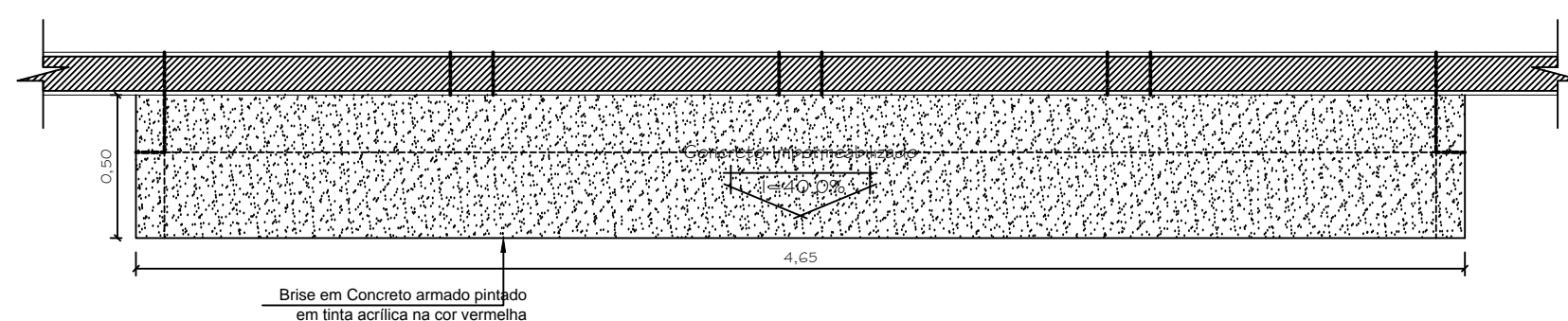

PLANTA SUPERIOR  
Brises Janela Wc. Fem./Masc.  
Escala: 1/25

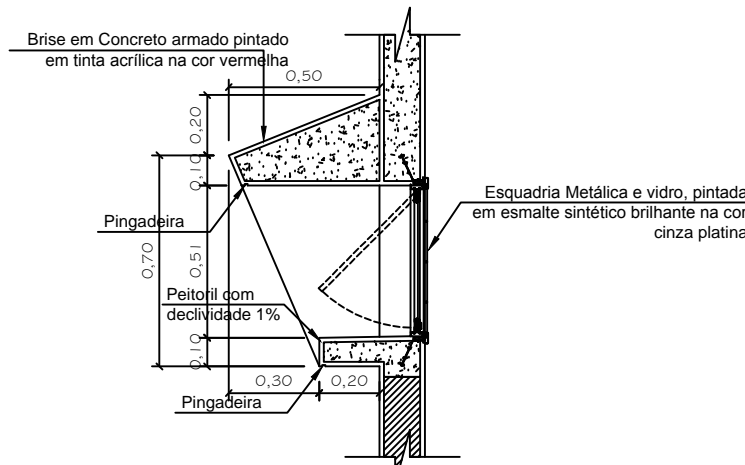

CORTE AA  
Brises Janela Wc. Fem./Masc.  
Escala: 1/25

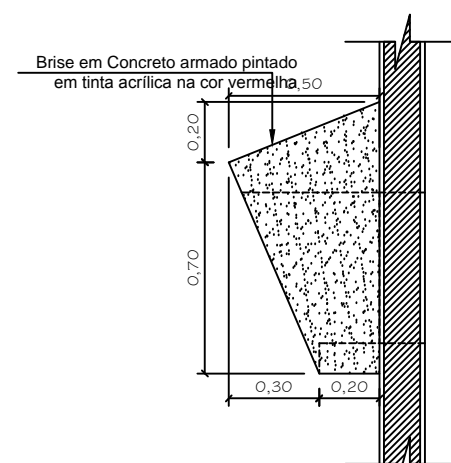

VISTA LATERAL  
Brises Janela Wc. Fem./Masc.  
Escala: 1/25



Schuring & Schuring Ltda.

Escritório Técnico B.E. SCHURING - Projetos Estruturais  
Av. XV de Novembro, 489 - Porto 2o. Andar - Cuiabá MT  
Fone: (065) 3321 9959 - Fax: (065) 3623 5066 - Internet: Email - schuring@schuring.com.br

RESP. TEC. EXECUÇÃO:

Eng. Civil

E.M.E.B  
ALINO FERREIRA

PROJETO  
ARQUITETURA

CLIENTE

REVISÃO

EMIÇÃO

DISCRIMINAÇÃO

DATA

PROJ.

DES.

VERIF.

APROV.

AV. VERDÃO, ESQ. COM RUA B., PARQUE DO LAGO  
VÁRZEA GRANDE - MT

CONTEÚDO:  
DETALHE: BRISAS - BR-05, BR-06 E BR-07

DATA:  
MAY/2017

ESCALA:  
INDICADA

DIREITOS AUTORAIS RESERVADOS  
VERIFICAR MEDIDAS NA OBRA

ARQUIVO

FOLHA No.  
18/36